



hpcorse [®]
MADE IN ITALY

EXHAUSTS CATALOGUE
ROYAL ENFIELD HIMALAYAN 450

ENG



Whilst maintaining a connection with its predecessor, **the new HIMALAYAN 450** has mightily impressed the Adventure market. This time, the Indian manufacturer hit it big revamped bodywork, upgraded chassis, prime features and at its heart, a brand new, a 452 cc single-cylinder liquid-cooled engine delivering more power, torque and speed.

The Himalayan 450 astonishes for its **bare-bones simplicity** even if less “crude” than the previous models, this bike not only embodies simplicity embodied in a motorcycle but also reincarnates the **adventure lifestyle**.

The all-new Royal Enfield Himalayan 450 connects rider, machine, and terrain. As the manufacturer itself says, it is built for all roads, built for no roads - a one-way ticket to adventure.

Hp Corse embraced the concept of the past in a new form by developing **a complete rally system made of four separate modules, fully interchangeable with the factory setup**:

- **SP-1 SHORT silencer** - available in satin finish or with CERAKOTE® ceramic coating (EURO 5 APPROVED)
- **Central link pipe** - to remove the standard Silence Box (ONLY FOR RACE PARTS)
- **Non-catalyzed primary collector** (ONLY FOR RACE PARTS)
- **A dedicated frame spacer kit to fit the original luggage pannier racks.**

The **SP-1 SHORT silencer** combines **technology and power in just 300 mm**. The **oval-shaped body** is made of high-quality, **ultra-light stainless steel finished** off with the **HP Corse laser engraved logo**. The exhaust features **conical end caps**, a **seamless outlet obtained through a refined deformation process** and a stainless steel link pipe equipped with with a glossy **carbon cover**. **Euro5 approved**. Assembly instructions provided.

Hassle-free installation is guaranteed when fitting the HP Corse exhaust with the original Royal Enfield side luggage racks thanks to the **specific powder-coated black spacers kit** containing everything needed for proper assembly. REHI45-V frame spacer kit is sold separately.

HP Corse further heeds the call of the open road with a special **racing optional upgrade**: the stainless steel **central link pipe aimed at remove of the original Silence Box** and the stainless steel **decat primary collector** . Aggressive sound and enhanced performance worthy of a true adventure machine are served at almost half the weight of the original equipment (**ORIGINAL EXHAUST SYSTEM 7.52 kg; HP CORSE 3.64 kg**) with **no ECU flashing needed**.

N.B. The PRIMARY COLLECTOR REHI45-C and the CENTRAL LINK PIPE REHI45-D DO NOT MEET EMISSION COMPLIANCE REQUIREMENTS FOR ROAD OR HIGHWAY USE.

NOTE: ALL THE COMPONENTS ARE INTERCHANGEABLE WITH THE ORIGINAL ONES



1 - SILENCER SP-1 300 SLIP-ON STREET LEGAL APPROVED EURO 5



HOMOLOGATED
EURO 5

■ SATIN FINISHED STAINLESS STEEL SP-1 300 SILENCER Code: REHI45SP1SS-AB

■ MATT BLACK CERAKOTE® STAINLESS STEEL SP-1 300 SILENCER Code: REHI45SP1SC-AB

TECHNICAL DATA

- Oval body crafter from ultra light stainless steel
- Streamlined design: 300 mm muffler sleeve, 0,8 thick
- Molded oval bottoms
- High quality sound-absorbing material
- Stainless steel bracket hand welded with TIG
- Carbon fiber pipe shield cover
- HP Corse Laser engraved logo
- Weight 2.158 gr.
- Street Legal approved - Euro 5



weight 2.158 gr.



Details:
seamless outlet, conical end caps, laser engraved logo, carbon fiber heat shield

➤ SATINATED STAINLESS
Code: REHI45SP1SS-AB



➤ MATT BLACK CERAKOTE®
Code: REHI45SP1SC-AB



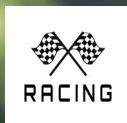

ONLY FOR RACE
PARTS

> RACING FULL-KIT

- SATINATED STAINLESS SP-1 300 SILENCER Code REHI45SP1SS-AB
- PRIMARY COLLECTOR Code: REHI45-C
- CENTRAL LINK-PIPE Code: REHI45-D



2 - **SPACER KIT** FITTING THE ORIGINAL SIDE PANNIER RACKS

KIT Code: REH145-V

Hassle-free installation is guaranteed when fitting the HP Corse exhaust with the original Royal Enfield side luggage racks thanks to the specific powder-coated black spacer kit which contains everything needed for proper assembly. REH145-V frame spacer kit is sold separately.

Everything needed for proper assembly is included.

REH145-V spacer kit is sold separately.

This optional accessory is mandatory if the motorcycle is equipped with original side pannier rack.

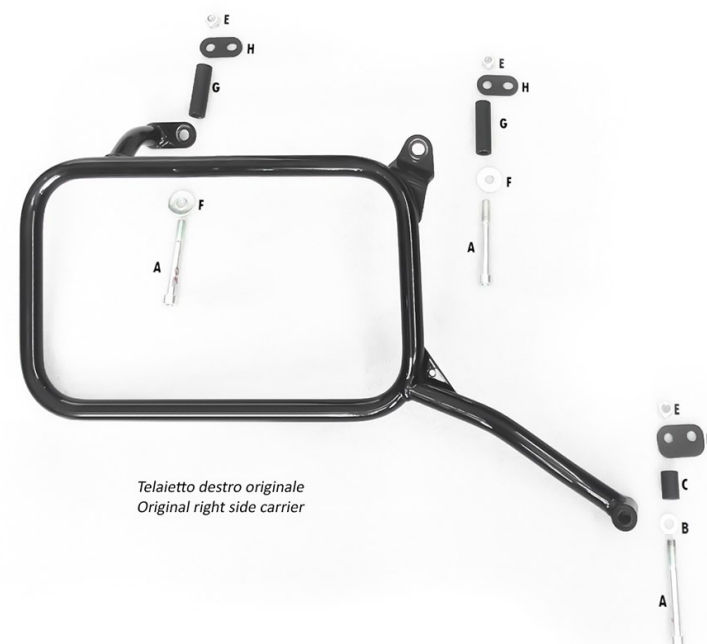
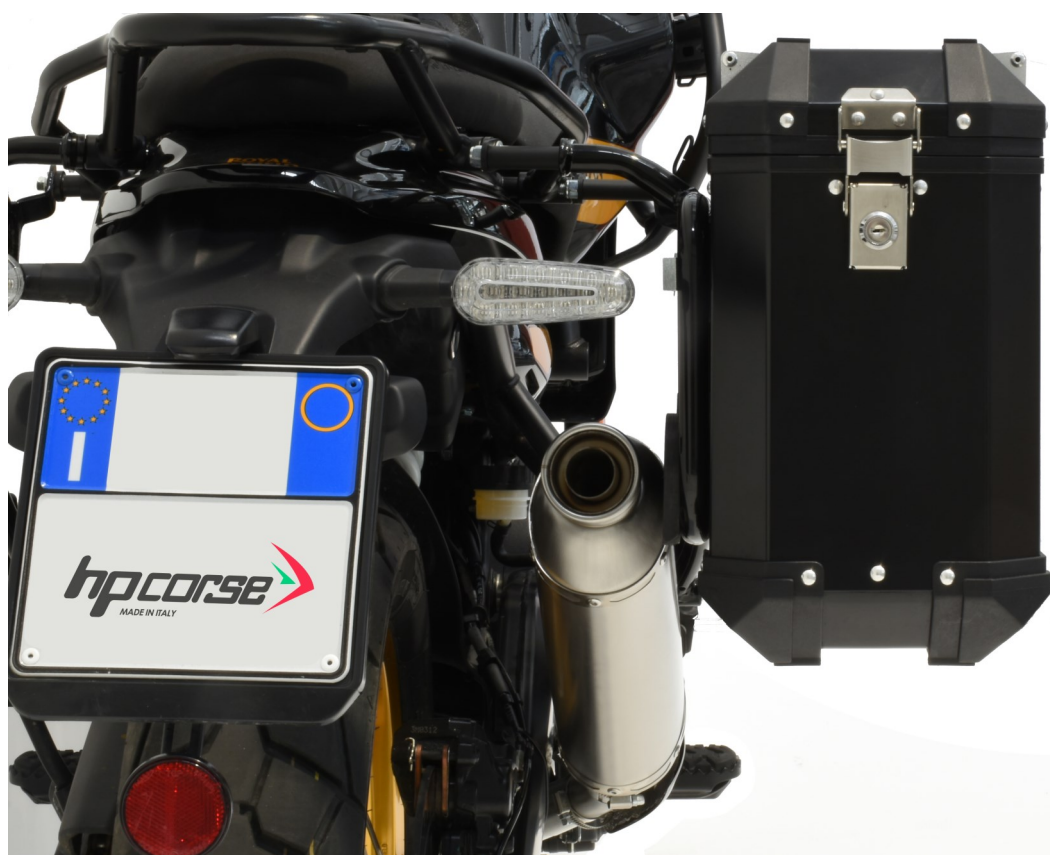
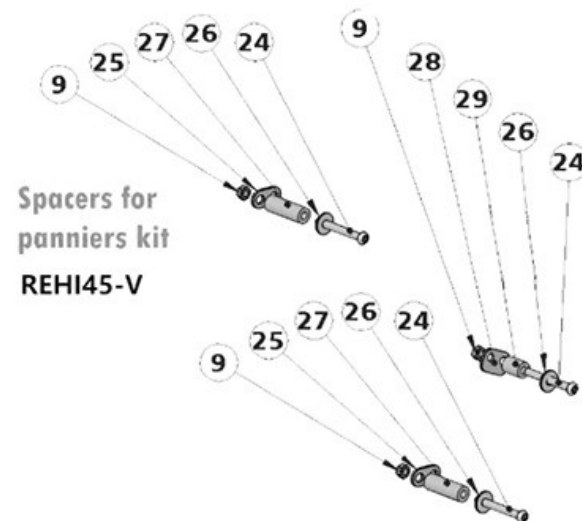



3 - **PRIMARY COLLECTOR** ONLY FOR RACE PARTS

4 - **CENTRAL LINK-PIPE** ONLY FOR RACE PARTS



ONLY FOR RACE
PARTS

PRIMARY COLLECTOR (REPLACES THE CATALYZED PRIMARY MANIFOLD) Code: **REHI45-C**
CENTRAL LINK-PIPE (REPLACES THE ORIGINAL SILENCE BOX) Code: **REHI45-D**



➤ PRIMARY COLLECTOR

Codice: **REHI45-C**



➤ CENTRAL LINK-PIPE

Codice: **REHI45-D**



Code: REHI45SP1SS-AB + REHI45-C + REHI45-D

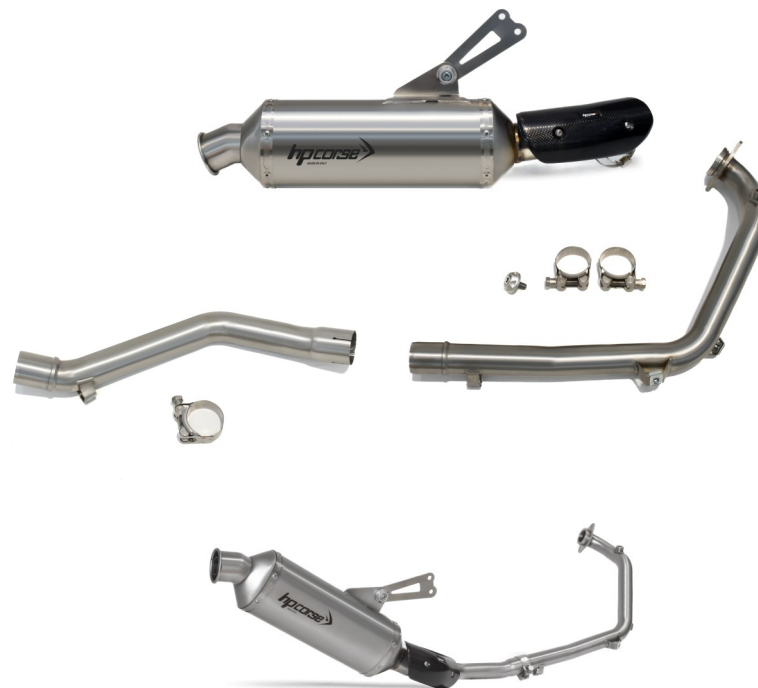

FULL KIT HP CORSE 3.64 Kg

ORIGINAL EXHAUST 7.52 KG



If the approved SILENCER is combined with the PRIMARY COLLECTOR and/or the CENTRAL LINK-PIPE, the warranty and approval of the SILENCER will expire. The vehicle will no longer be able to circulate on roads open to traffic. HP CORSE declines all responsibility for the inappropriate use of these components.

HP Corse further heeds the call of the open road with a special **racing optional upgrade**: the stainless steel **central link pipe** to remove the **original Silence Box** and the stainless steel **decat primary collector** aggressive sound and enhanced performance worthy of a true adventure machine are served at almost half the weight of the original equipment (**ORIGINAL EXHAUST SYSTEM 7.52 kg; HP CORSE 3.64 kg**) with no **ECU flashing** needed.





HIMALAYAN 450



BY Steelform s.r.l.
C.F. P.I. 01698860309
Via Max Piccini, 16-33061 RIVIGNANO-TEOR (UDINE)
Via Udine, 60-33061 RIVIGNANO-TEOR (UDINE)
www.hpcorse.com
info@hpcorse.com
commerciale@hpcorse.com
Tel. +39 0432 822 200
Fax +39 0432 822 231
WhatsApp +393290072274

The brand "HP CORSE" and all the products in this catalog are owned by HPCORSE S.R.L.
(all rights reserved)